

## ONE YEAR LIMITED WARRANTY

This SKUTCH PRODUCT is warranted against defects for a period of one (1) year from the date of original invoice. Within this period, we will repair the PRODUCT without charge for parts and labor. To obtain warranty service the product must be returned, at the customer's expense, to SKUTCH Electronics along with a copy of the original invoice. After the unit has been repaired, SKUTCH will ship the PRODUCT back via UPS GROUND service at our expense. If any other form of return shipment is requested, the customer will pay for 100% of the shipping cost.

This Warranty does not apply if in the sole opinion of SKUTCH Electronics, the product has been damaged by lightning or any other Acts of God, or by accident, misuse, neglect, or improper packing, shipping, modification or servicing by other than an authorized SKUTCH Service Center.

EXCEPT AS SPECIFICALLY PROVIDED IN THIS AGREEMENT, THERE ARE NO OTHER WARRANTIES, EXPRESSED OR IMPLIED, INCLUDING, BUT NOT LIMITED TO, ANY IMPLIED WARRANTIES OR MERCHANTABILITY OR FITNESS FOR A PARTICULAR PURPOSE AND IN NO EVENT SHALL SKUTCH ELECTRONICS BE LIABLE FOR LOSS OF PROFITS OR BENEFITS, INDIRECT, SPECIAL, CONSEQUENTIAL OR OTHER SIMILAR DAMAGES ARISING OUT OF ANY BREACH OF THIS WARRANTY OR OTHERWISE.

**SKUTCH** ELECTRONICS, INC.  
209 Kenroy Lane #9  
Roseville, California 95678  
Voice (916) 786-6186      FAX (916) 783-1909  
E-MAIL [skutch@inreach.com](mailto:skutch@inreach.com)      <http://www.skutchelectronics.com>



**SKUTCH** 

---

  
"Telecommunication Products to solve Telecommunication Problems"



# BA-1

**Hold Button Adapter for use with BA-704 series**

SN A112001 and above

## Introduction

Thank you for purchasing the Skutch BA-1 Hold Button Adapter for use with the BA-704 series Promotion-On-Hold modules. The BA-1 mounts directly to your corded telephone and becomes an integral part of the phone itself. It supplies a HOLD BUTTON and four "IN-USE" lights that show the accurate status of each telephone line. The BA-1 is perfect for heavy use phones where properly functioning "IN-USE" lights and easy to use HOLD functions are mandatory. A separate BA-1 should be installed on each high traffic corded telephone. Other phones and all cordless phones can still use the STAR tone to activate the Promotion-On-Hold system. The BA-1 requires that a Skutch BA-704 Promotion-On-Hold module be used on one of the telephones.

## Installation Diagram

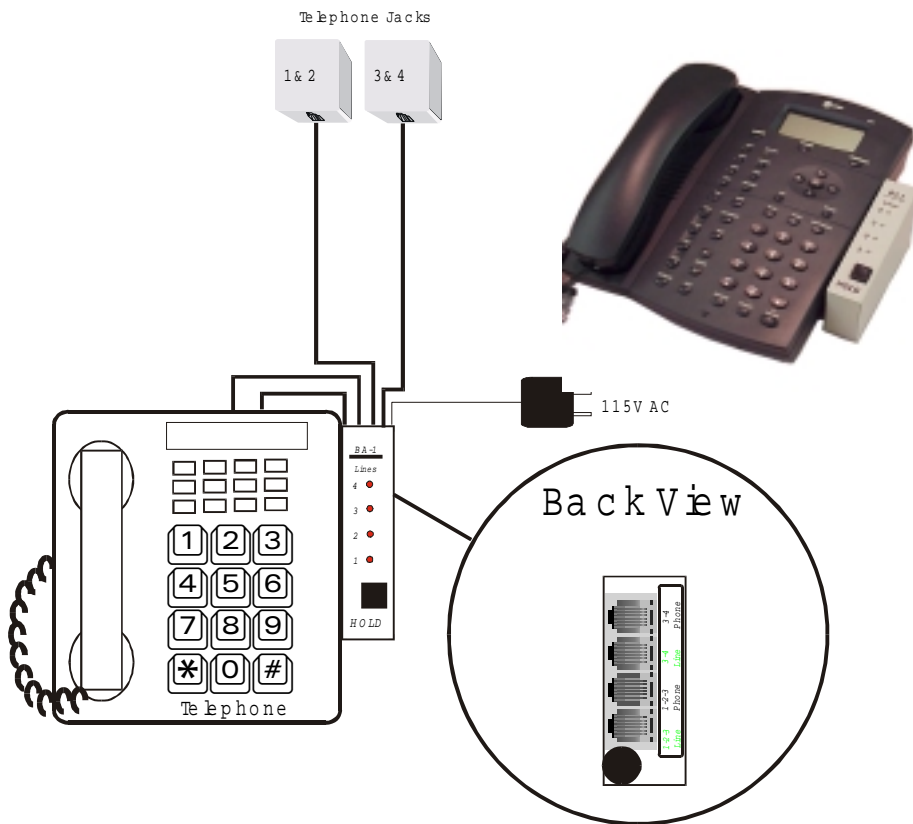

## Placing A Call ON HOLD

Press the hold button and hang up the telephone or select another line within 6 seconds of pressing the button.

## Taking a call off hold

Simply select the line and pick up the phone.

## Status of "IN-USE" Lights

- OFF** : Indicates line is hung up and not in use.
- Steady RED** : Another phone is currently using the line, or line is not connected to BA-1.
- Steady GREEN** : Line is being used by this phone.
- Flashing RED** : Another phone has placed the call ON HOLD.
- Flashing GREEN** : This phone has placed the line ON HOLD.

## Disabling a non used "IN-USE" light

If you have less than four lines then the unused "IN-USE" lights on the BA-1 will stay lit RED. If you wish you may disable the unused lights by pressing and holding down the BA-1 HOLD button until only the desired lights are lit up YELLOW. At this point release the HOLD button. The BA-1 will retain this information until the unit is disconnected from power.

## Power Up

On initial power up, the lights will alternately flash RED and GREEN for 2 seconds.

## Tech Support - 916-786-6186

If you have any problems getting the BA-1 to work properly feel free to give us a call. Technical Support is available between the hours of 7:30 AM and 4:30 PM Pacific Time, Monday through Friday.