

## • Introduction

Thank you for purchasing the BA-2 Promotion-On-Hold Adapter. This unit can be used by itself, as a single station adapter, or it can be used on an AS-702 non-compatible phone, to make it compatible. The BA-2 is simple to use and is compatible with almost every make and model of telephone.

## • Installation

To install the unit on either a two line or single line telephone, follow the four steps below:

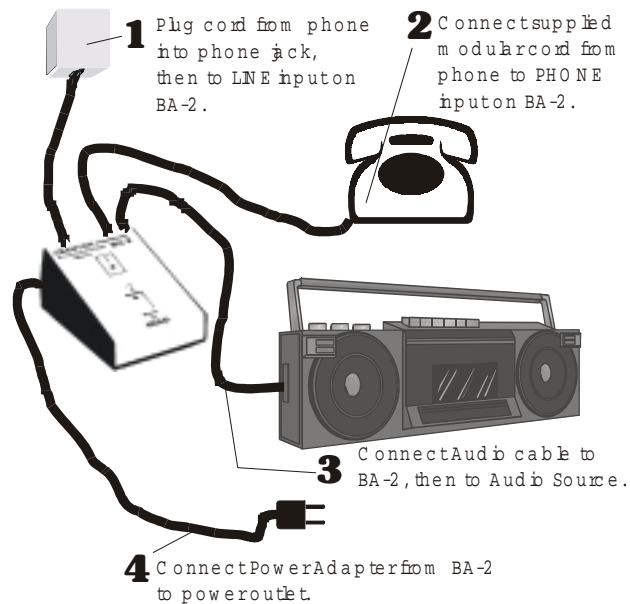

## • Operation

### • To place a call on hold

Simply press the **HOLD** button on the BA-2, then hang up.

### • To release the hold condition

Pick up any phone that is connected to that line, and the adapter will automatically reset.

## • Front Panel Lights

### • Steady On

Indicates that line is currently in use by the phone. The light does not light when another phone is using the line.

### • Fast Flash

Indicates that the unit has detected that you have pressed the BA-2's **HOLD** button and is ready for you to hang up so that the BA-2 can hold the call. You can reset the unit by pressing the **HOLD** button once again.

### • Slow Flash

Indicates that a call is ON HOLD.

### • Power Up

On initial power up, the light will alternately flash for 3 seconds.

### • Light Switch (back panel)

This switch is normally in position #3. Change the switch to a different setting if other phone's IN-USE lights do not light when the BA-2 is in the hold condition.

### • Audio Input (back panel)

This input is connected to your audio source. Use the phones or speaker output to drive this input. A pre-amp level output is not loud enough.

### • Tech Support - 916-786-6186

If you have any problems getting the unit to work properly feel free to give us a call. Technical Support is available between the hours of 7:30 AM and 4:30 PM Pacific Time, Monday through Friday.

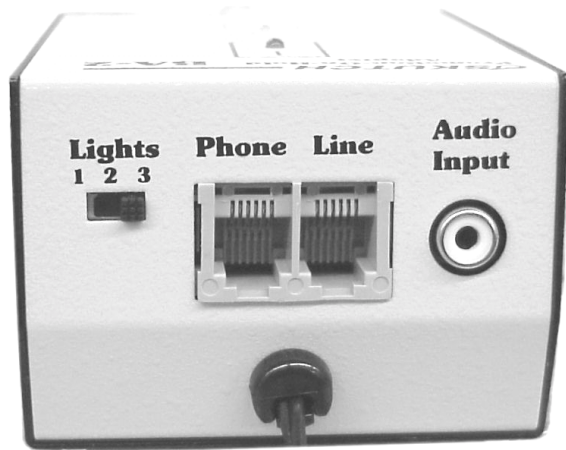

**SKUTCH** —  
"Telecommunication Products to solve Telecommunication Problems"

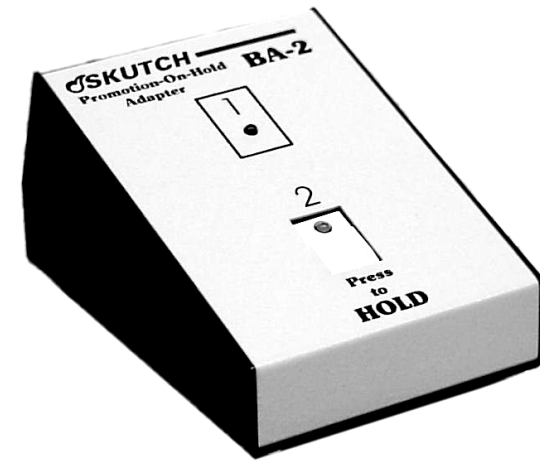

## • ONE YEAR LIMITED WARRANTY

This SKUTCH PRODUCT is warranted against defects for a period of one (1) year from the date of the original invoice. Within this period, we will repair it without charge for parts and labor. To obtain warranty service the product must be returned, at the customer's expense, to SKUTCH Electronics along with a copy of the original invoice. After the unit has been repaired, SKUTCH will ship the PRODUCT back via UPS GROUND service at our expense. If any other form of return shipment is requested, the customer will pay for 100% of the shipping cost.

This Warranty does not apply if in the sole opinion of SKUTCH Electronics, the PRODUCT has been damaged by lightning or any other Acts of God, or by accident, misuse, neglect, or improper packing, shipping, modification or servicing by other than an authorized SKUTCH Service Center.

EXCEPT AS SPECIFICALLY PROVIDED IN THIS AGREEMENT, THERE ARE NO OTHER WARRANTIES, EXPRESSED OR IMPLIED, INCLUDING, BUT NOT LIMITED TO, ANY IMPLIED WARRANTIES OR MERCHANTABILITY OR FITNESS FOR A PARTICULAR PURPOSE AND IN NO EVENT SHALL SKUTCH ELECTRONICS BE LIABLE FOR LOSS OF PROFITS OR BENEFITS, INDIRECT, SPECIAL, CONSEQUENTIAL OR OTHER SIMILAR DAMAGES ARISING OUT OF ANY BREACH OF THIS WARRANTY OR OTHERWISE.

# BA-2 Manual Promotion On Hold Adapter Version 1.0